

NOTES:

1. Material : Spring Steel
2. Finish : Zinc - Z
3. Ends : Closed
4. Total Coils : 7.000
5. Sugg. Max. Deflection : 1.800 (in)
6. Sugg. Max. Load : 27.000 (lbs)
7. All Drawing Dimensions are in Inches [mm]

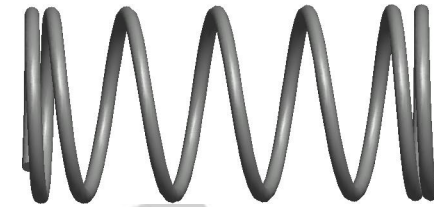

Ø 0.105
[2,67]
WIRE DIA

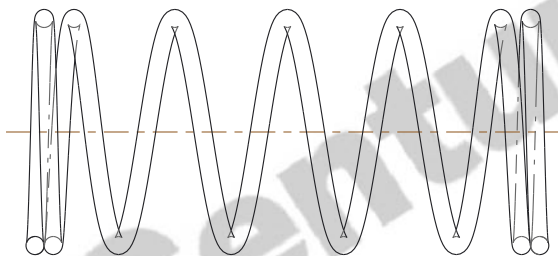

1.910
[48,51]
LENGTH

Ø 1.421
[36,09]
O.D

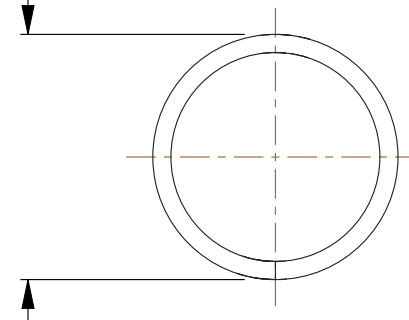

COMPONENT		SPRINGS	
11930 COMPRESSION SPRINGS		UNIT	
		INCH [mm]	
		SHEET	1 of 1