

**NOTES:**

1. Material : Music Wire
2. Finish : Glod Irridite
3. Ends : Closed
4. Total Coils : 8.000
5. Sugg. Max. Deflection : 0.130 (in)
6. Sugg. Max. Load : 0.230 (lbs)
7. All Drawing Dimensions are in Inches [mm]

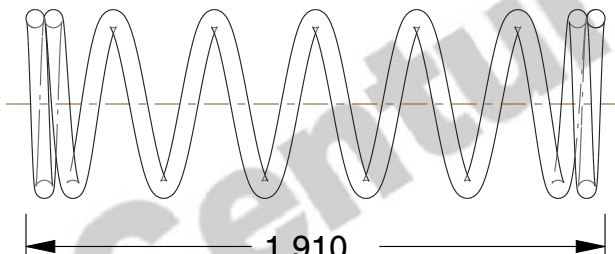

Ø 0.006  
[0,15]  
WIRE DIA



1.910  
[48,51]  
LENGTH

Ø 0.062  
[1,57]  
O.D

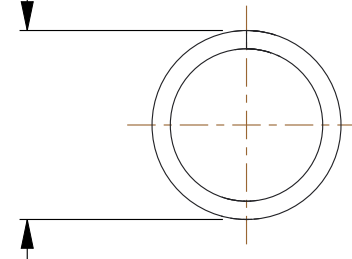

COMPONENT		SPRINGS	
12496 COMPRESSION SPRINGS		UNIT	
		INCH [mm]	
		SHEET	1 of 1