

**NOTES:**

1. Material : Music Wire
2. Finish : Zinc - Z
3. Ends : Closed
4. Total Coils : 4.000
5. Sugg. Max. Deflection : 0.400 (in)
6. Sugg. Max. Load : 5.500 (lbs)
7. All Drawing Dimensions are in Inches [mm]

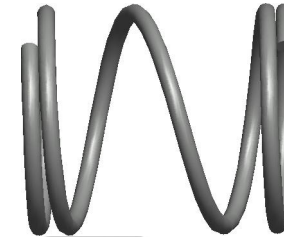

Ø 0.037  
[0,94]  
WIRE DIA

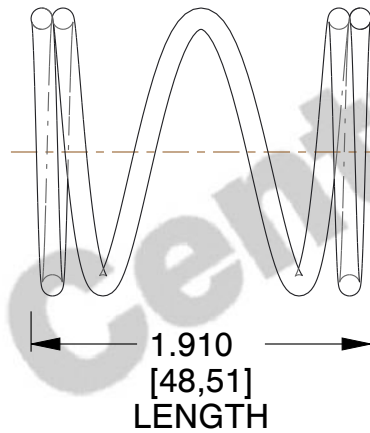

Ø 0.500  
[12,70]  
O.D

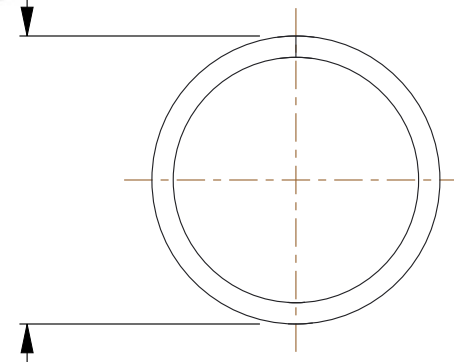

COMPONENT		SPRINGS	
12673 COMPRESSION SPRINGS		UNIT	
		INCH [mm]	
		SHEET	1 of 1