

NOTES:

1. Material : Music Wire
2. Finish : Zinc - Z
3. Ends : Closed
4. Total Coils : 19.800
5. Sugg. Max. Deflection : 1.100 (in)
6. Sugg. Max. Load : 3.300 (lbs)
7. All Drawing Dimensions are in Inches [mm]

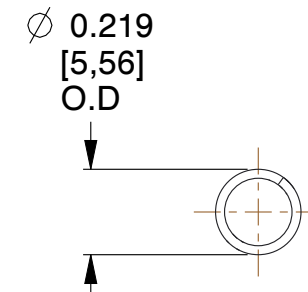
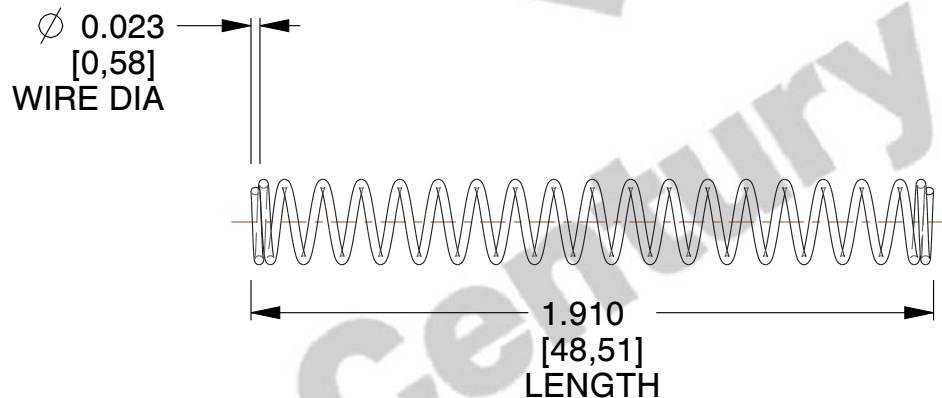

COMPONENT		SPRINGS	
161-C COMPRESSION SPRINGS		UNIT	
		INCH [mm]	
		SHEET	1 of 1