

**NOTES:**

1. Material : Music Wire
2. Finish : Zinc - Z
3. Ends : Closed
4. Total Coils : 14.500
5. Sugg. Max. Deflection : 0.240 (in)
6. Sugg. Max. Load : 0.420 (lbs)
7. All Drawing Dimensions are in Inches [mm]

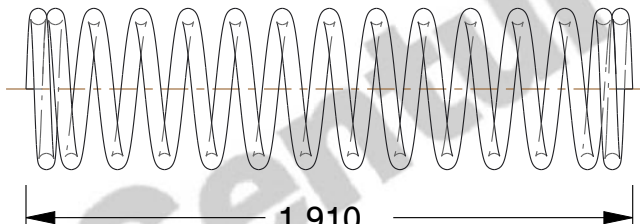

Ø 0.011  
[0,28]  
WIRE DIA



1.910  
[48,51]  
LENGTH

Ø 0.109  
[2,77]  
O.D

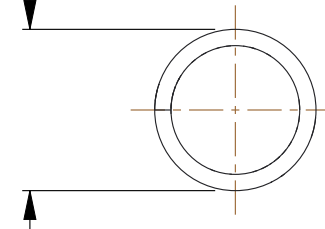

COMPONENT		SPRINGS	
2937 COMPRESSION SPRINGS		UNIT	
		INCH [mm]	
		SHEET	1 of 1