

**NOTES:**

1. Material : Music Wire
2. Finish : Zinc - Z
3. Ends : Closed
4. Total Coils : 8.000
5. Sugg. Max. Deflection : 0.740 (in)
6. Sugg. Max. Load : 0.760 (lbs)
7. All Drawing Dimensions are in Inches [mm]

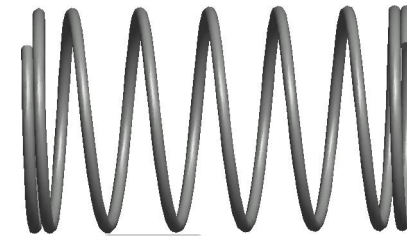

Ø 0.029  
[0,74]  
WIRE DIA

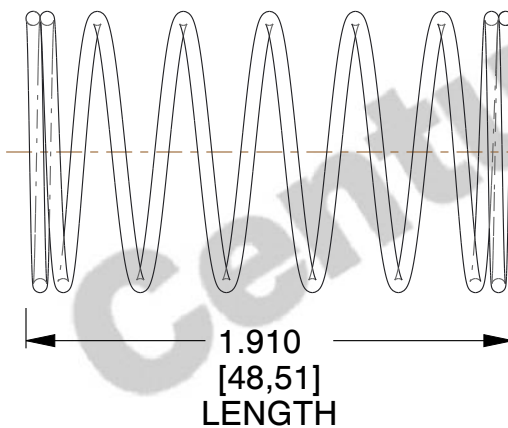

Ø 0.578  
[14,68]  
O.D

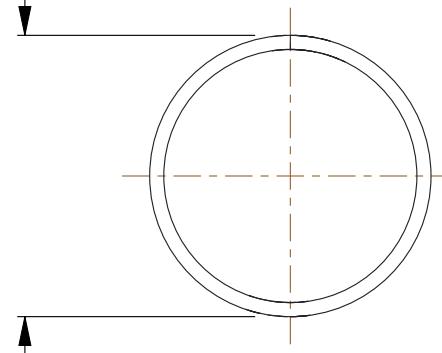

COMPONENT		SPRINGS	
2960  COMPRESSION SPRINGS		UNIT	
		INCH [mm]	
		SHEET	1 of 1