

NOTES:

1. Material : Music Wire
2. Finish : Glod Irridite
3. Ends : Closed and Ground
4. Total Coils : 17.600
5. Sugg. Max. Deflection : 0.730 (in)
6. Sugg. Max. Load : 2.600 (lbs)
7. All Drawing Dimensions are in Inches [mm]

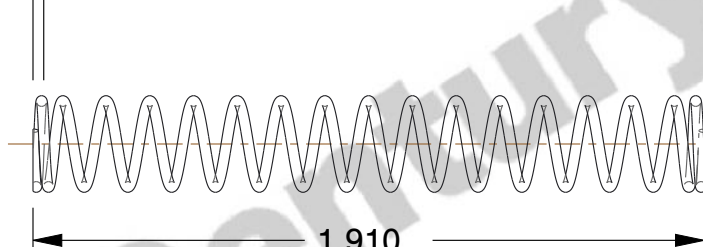

Ø 0.020
[0,51]
WIRE DIA



1.910
[48,51]
LENGTH

GROUND
SURFACE

Ø 0.180
[4,57]
O.D

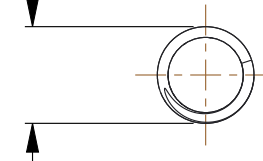

COMPONENT		SPRINGS	
70339 COMPRESSION SPRINGS		UNIT	
		INCH [mm]	
		SHEET	1 of 1