

NOTES:

1. Material : Music Wire
2. Finish : Glod Irridite
3. Ends : Closed and Ground
4. Total Coils : 9.000
5. Sugg. Max. Deflection : 0.550 (in)
6. Sugg. Max. Load : 6.100 (lbs)
7. All Drawing Dimensions are in Inches [mm]

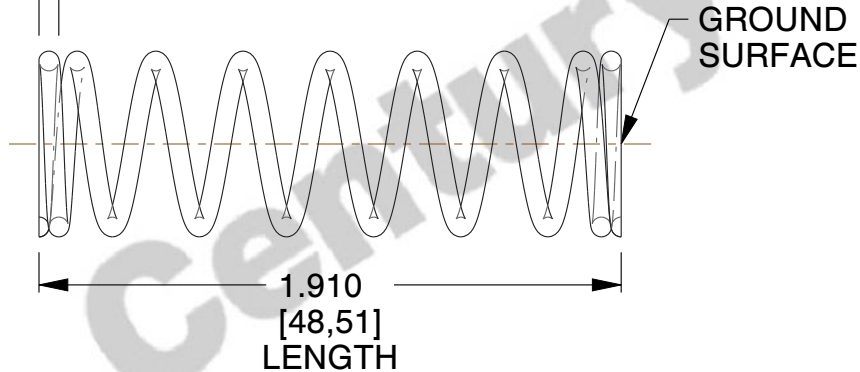

Ø 0.032
[0,81]
WIRE DIA



Ø 0.300
[7,62]
O.D

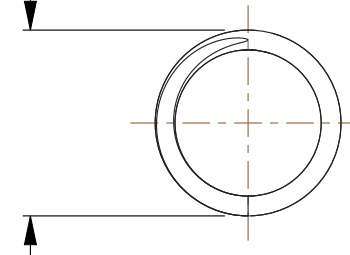

COMPONENT		SPRINGS	
70856 COMPRESSION SPRINGS		UNIT	
		INCH [mm]	
		SHEET	1 of 1