

**NOTES:**

1. Material : Music Wire
2. Finish : Glod Irridite
3. Ends : Closed and Ground
4. Total Coils : 26.000
5. Sugg. Max. Deflection : 0.800 (in)
6. Sugg. Max. Load : 21.000 (lbs)
7. All Drawing Dimensions are in Inches [mm]

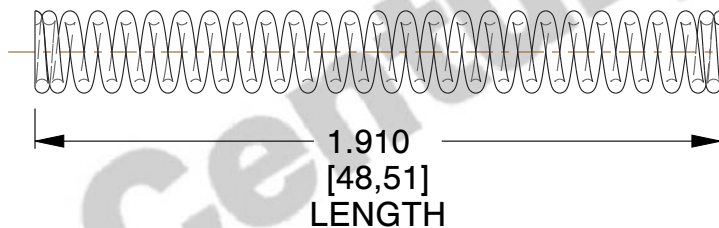

Ø 0.051  
[1,30]  
WIRE DIA



GROUND  
SURFACE

Ø 0.300  
[7,62]  
O.D

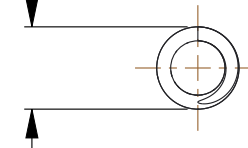

COMPONENT		SPRINGS	
71023  COMPRESSION SPRINGS		UNIT	
		INCH [mm]	
		SHEET	1 of 1