

**NOTES:**

1. Material : Music Wire
2. Finish : Glod Irridite
3. Ends : Closed and Ground
4. Total Coils : 4.500
5. Sugg. Max. Deflection : 0.190 (in)
6. Sugg. Max. Load : 11.000 (lbs)
7. All Drawing Dimensions are in Inches [mm]

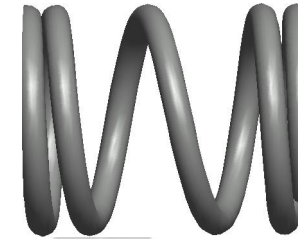

Ø 0.042  
[1,07]  
WIRE DIA

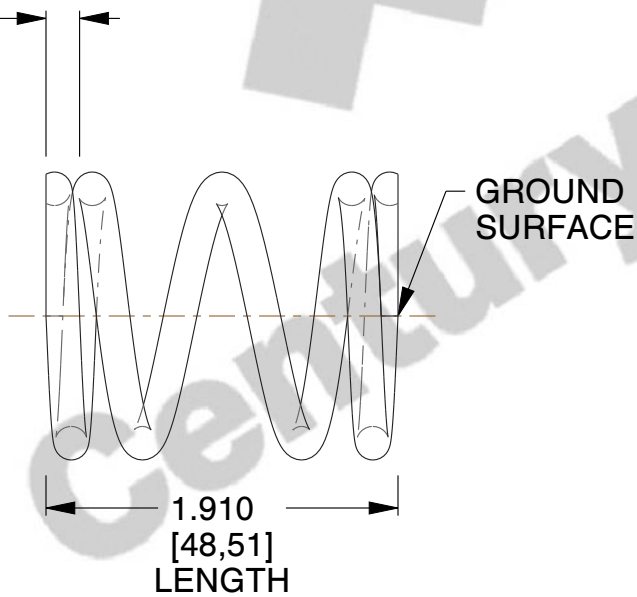

Ø 0.360  
[9,14]  
O.D

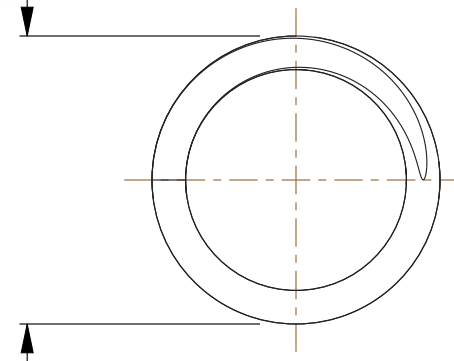

COMPONENT		SPRINGS	
71137 COMPRESSION SPRINGS		UNIT	
		INCH [mm]	
		SHEET	1 of 1