

NOTES:

1. Material : Music Wire
2. Finish : Glod Irridite
3. Ends : Closed and Ground
4. Total Coils : 4.630
5. Sugg. Max. Deflection : 0.270 (in)
6. Sugg. Max. Load : 12.000 (lbs)
7. All Drawing Dimensions are in Inches [mm]

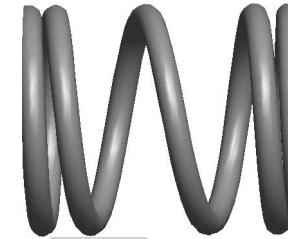

Ø 0.045
[1,14]
WIRE DIA

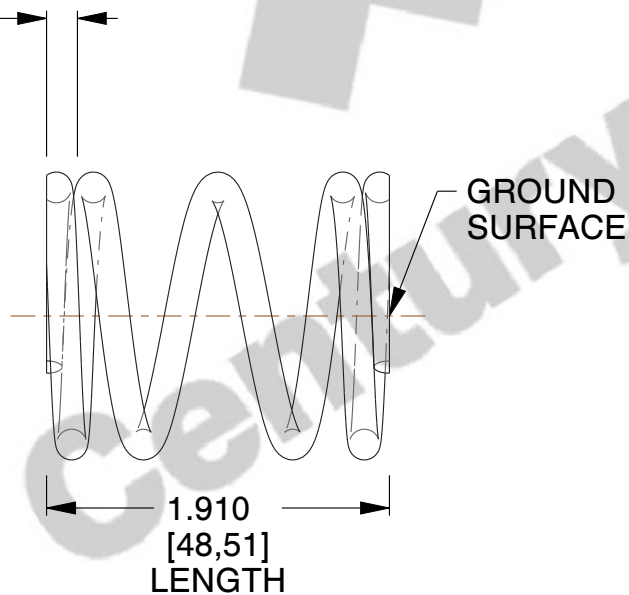

Ø 0.420
[10,67]
O.D

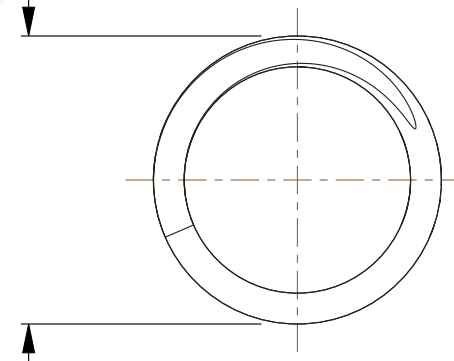

COMPONENT		SPRINGS	
71351 COMPRESSION SPRINGS		UNIT	
		INCH [mm]	
		SHEET	1 of 1