

**NOTES:**

1. Material : Music Wire
2. Finish : Glod Irridite
3. Ends : Closed and Ground
4. Total Coils : 4.500
5. Sugg. Max. Deflection : 0.240 (in)
6. Sugg. Max. Load : 13.000 (lbs)
7. All Drawing Dimensions are in Inches [mm]

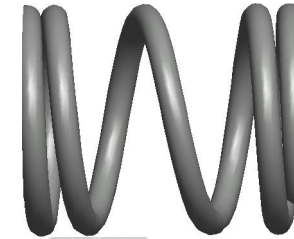

Ø 0.047  
[1,19]  
WIRE DIA

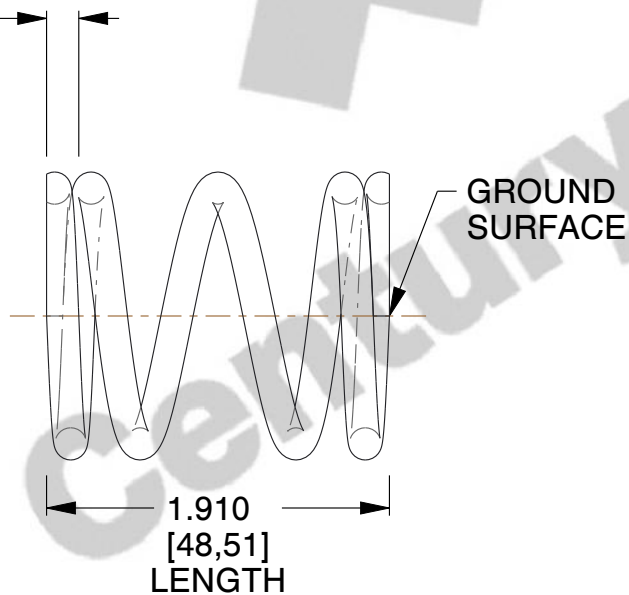

Ø 0.420  
[10,67]  
O.D

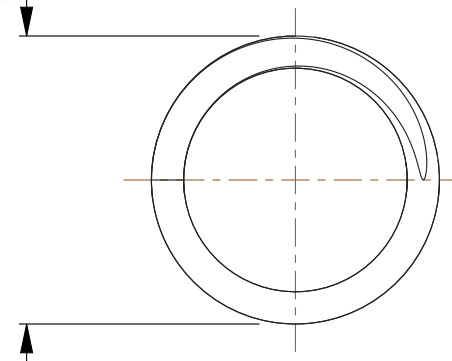

| COMPONENT           |  | SPRINGS   |  |
|---------------------|--|-----------|--|
| 71362               |  | UNIT      |  |
|                     |  | INCH [mm] |  |
|                     |  | SHEET     |  |
| COMPRESSION SPRINGS |  | 1 of 1    |  |