

**NOTES:**

1. Material : Music Wire
2. Finish : Glod Irridite
3. Ends : Closed and Ground
4. Total Coils : 4.380
5. Sugg. Max. Deflection : 0.330 (in)
6. Sugg. Max. Load : 21.000 (lbs)
7. All Drawing Dimensions are in Inches [mm]

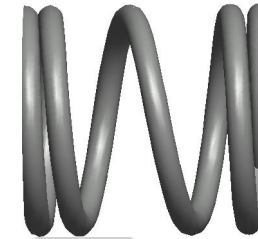

Ø 0.063  
[1,60]  
WIRE DIA

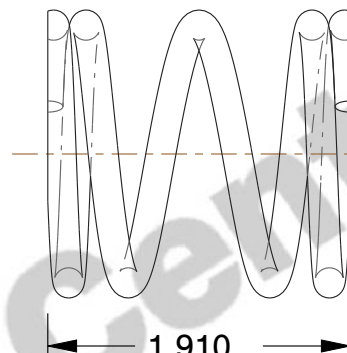

1.910  
[48,51]  
LENGTH

GROUND  
SURFACE

Ø 0.600  
[15,24]  
O.D

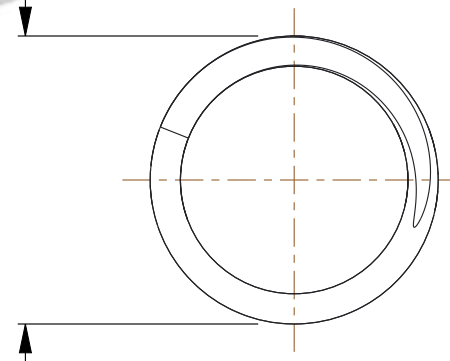

COMPONENT		SPRINGS	
71765 COMPRESSION SPRINGS		UNIT	
		INCH [mm]	
		SHEET	1 of 1