

NOTES:

1. Material : Music Wire
2. Finish : Glod Irridite
3. Ends : Closed and Ground
4. Total Coils : 4.630
5. Sugg. Max. Deflection : 0.250 (in)
6. Sugg. Max. Load : 72.000 (lbs)
7. All Drawing Dimensions are in Inches [mm]

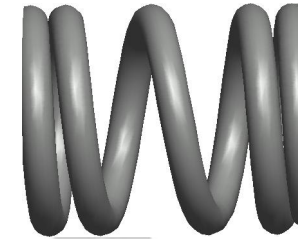

Ø 0.105
[2,67]
WIRE DIA

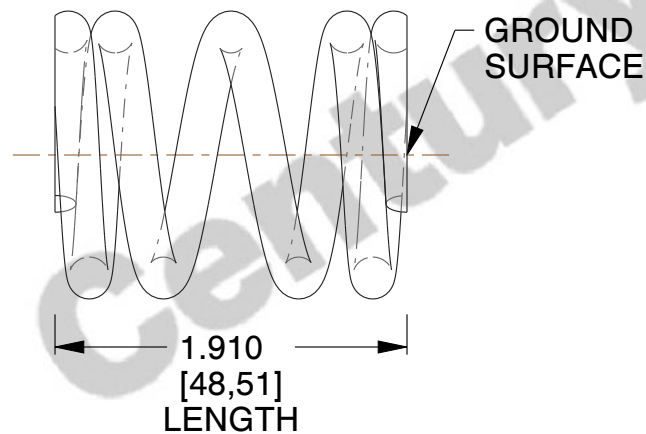

Ø 0.720
[18,29]
O.D

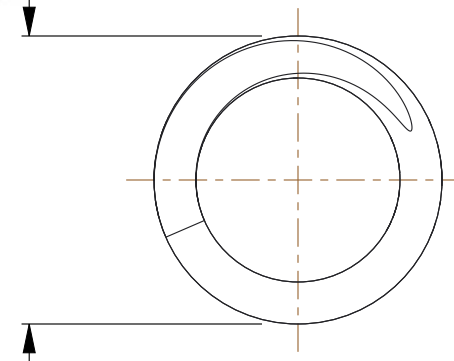

COMPONENT		SPRINGS	
72111 COMPRESSION SPRINGS		UNIT	
		INCH [mm]	
		SHEET	1 of 1