

NOTES:

1. Material : Music Wire
2. Finish : Glod Irridite
3. Ends : Closed and Ground
4. Total Coils : 5.380
5. Sugg. Max. Deflection : 0.440 (in)
6. Sugg. Max. Load : 226.000 (lbs)
7. All Drawing Dimensions are in Inches [mm]

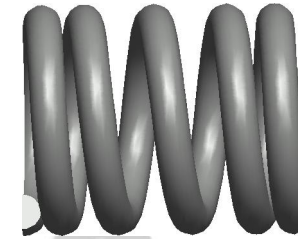

Ø 0.192
[4,88]
WIRE DIA

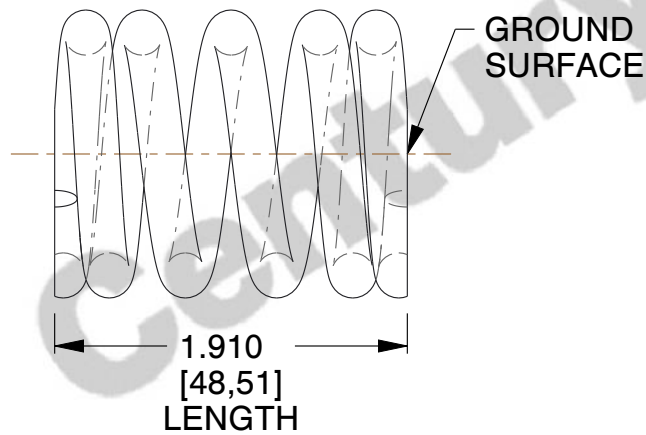

Ø 1.225
[31,12]
O.D

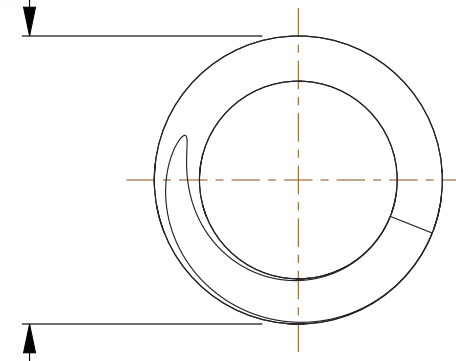

COMPONENT		SPRINGS	
72751 COMPRESSION SPRINGS		UNIT	
		INCH [mm]	
		SHEET	1 of 1