

NOTES:

1. Material : Music Wire
2. Finish : Glod Irridite
3. Ends : Closed
4. Total Coils : 7.000
5. Sugg. Max. Deflection : 0.140 (in)
6. Sugg. Max. Load : 3.900 (lbs)
7. All Drawing Dimensions are in Inches [mm]

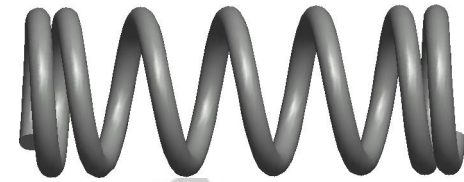

Ø 0.022
[0,56]
WIRE DIA

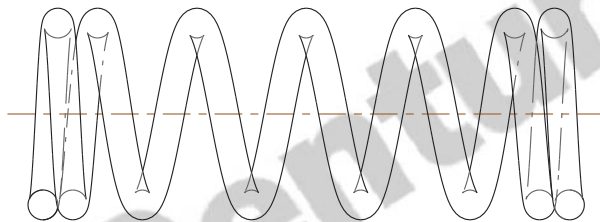

1.910
[48,51]
LENGTH

Ø 0.156
[3,96]
O.D

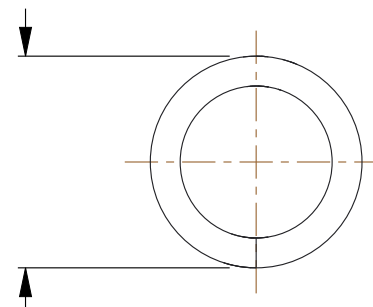

COMPONENT		SPRINGS	
B15-37 COMPRESSION SPRINGS		UNIT	
		INCH [mm]	
		SHEET	1 of 1