

**NOTES:**

1. Material : Music Wire
2. Finish : Glod Irridite
3. Ends : Closed
4. Total Coils : 4.000
5. Sugg. Max. Deflection : 0.150 (in)
6. Sugg. Max. Load : 1.100 (lbs)
7. All Drawing Dimensions are in Inches [mm]

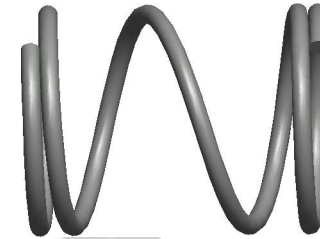

Ø 0.015  
[0,38]  
WIRE DIA

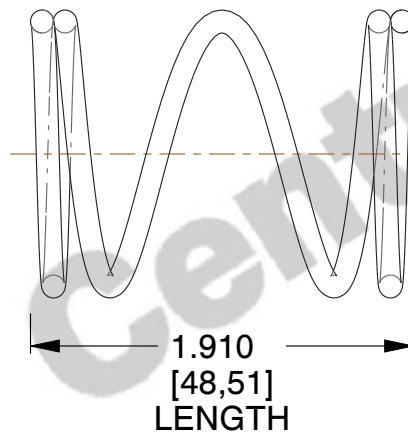

Ø 0.188  
[4,78]  
O.D

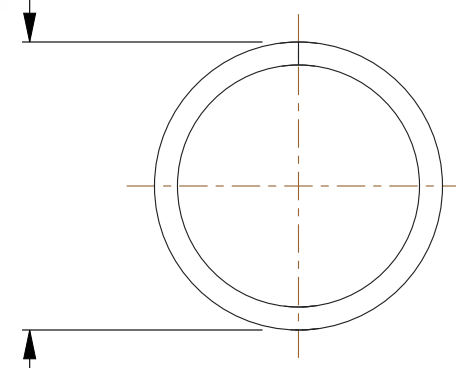

COMPONENT		SPRINGS	
FF-62  COMPRESSION SPRINGS		UNIT	
		INCH [mm]	
		SHEET	1 of 1