

NOTES:

1. Material : Music Wire
2. Finish : Glod Irridite
3. Ends : Closed
4. Total Coils : 6.000
5. Sugg. Max. Deflection : 0.230 (in)
6. Sugg. Max. Load : 1.300 (lbs)
7. All Drawing Dimensions are in Inches [mm]

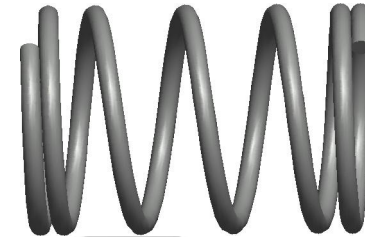

Ø 0.021
[0,53]
WIRE DIA

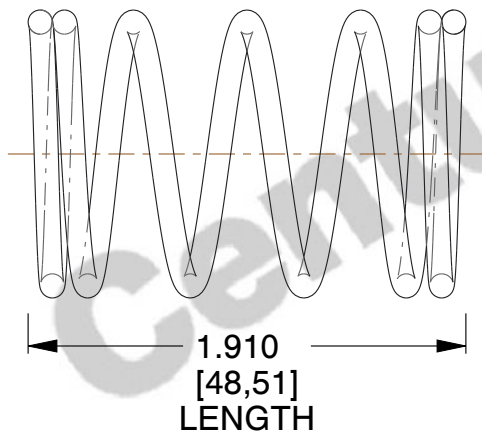

Ø 0.250
[6,35]
O.D

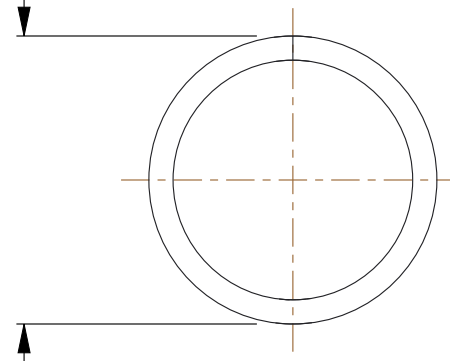

COMPONENT		SPRINGS	
LL-85 COMPRESSION SPRINGS		UNIT	
		INCH [mm]	
		SHEET	1 of 1