

**NOTES:**

1. Material : Spring Steel
2. Finish : Glod Irridite
3. Ends : Closed and Ground
4. Total Coils : 6.500
5. Sugg. Max. Deflection : 0.440 (in)
6. Sugg. Max. Load : 1.200 (lbs)
7. All Drawing Dimensions are in Inches [mm]

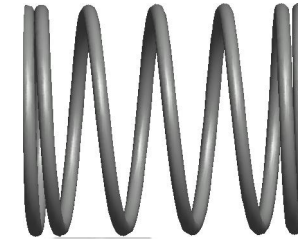

Ø 0.033  
[0,84]  
WIRE DIA

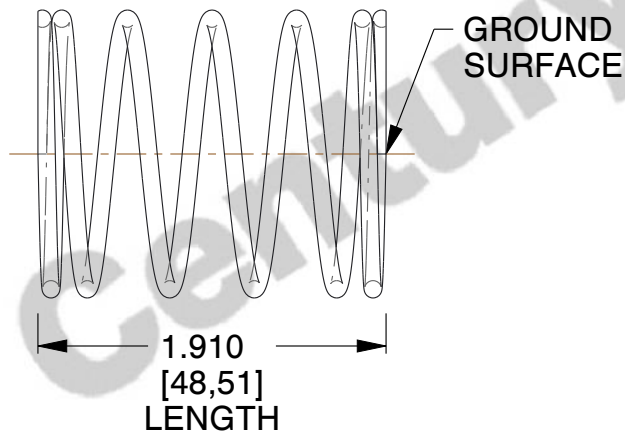

Ø 0.546  
[13,87]  
O.D

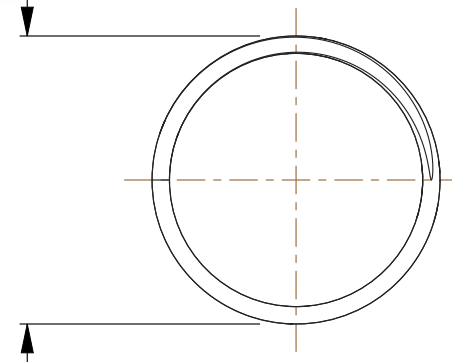

COMPONENT		SPRINGS	
M-109  COMPRESSION SPRINGS		UNIT	
		INCH [mm]	
		SHEET	1 of 1