

NOTES:

1. Material : Stainless Steel
2. Finish : Glod Irridite
3. Ends : Closed
4. Total Coils : 4.500
5. Sugg. Max. Deflection : 0.130 (in)
6. Sugg. Max. Load : 0.160 (lbs)
7. All Drawing Dimensions are in Inches [mm]

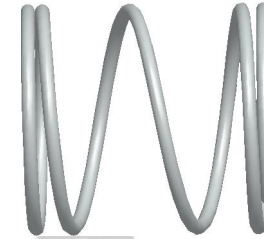

Ø 0.010
[0,25]
WIRE DIA

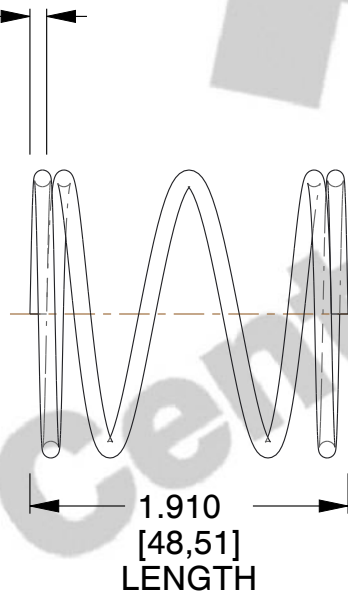

Ø 0.172
[4,37]
O.D

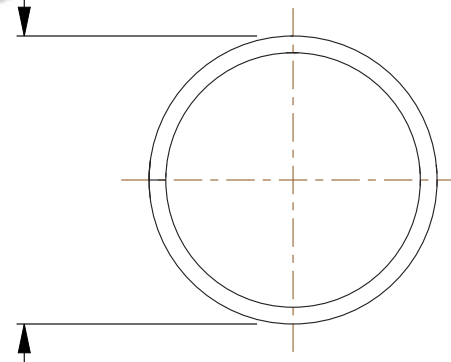

| COMPONENT | | SPRINGS | |
|-----------------------------------|--|-----------|--------|
| S-1093 COMPRESSION SPRINGS | | UNIT | |
| | | INCH [mm] | |
| | | SHEET | 1 of 1 |