

**NOTES:**

1. Material : Stainless Steel
2. Finish : Glod Irridite
3. Ends : Closed
4. Total Coils : 17.000
5. Sugg. Max. Deflection : 1.500 (in)
6. Sugg. Max. Load : 9.200 (lbs)
7. All Drawing Dimensions are in Inches [mm]

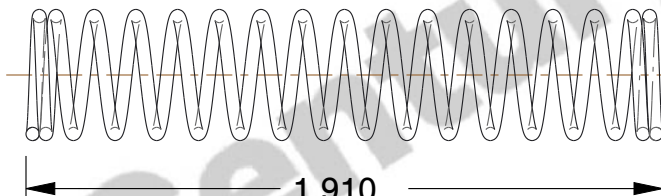

Ø 0.052  
[1,32]  
WIRE DIA



1.910  
[48,51]  
LENGTH

Ø 0.515  
[13,08]  
O.D

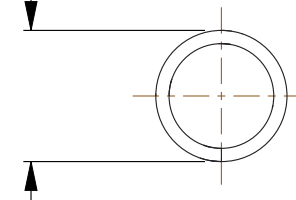

COMPONENT		SPRINGS	
S-278  COMPRESSION SPRINGS		UNIT	
		INCH [mm]	
		SHEET	1 of 1