

NOTES:

1. Material : Spring Steel
2. Finish : Glod Irridite
3. Ends : Closed and Ground
4. Total Coils : 4.000
5. Sugg. Max. Deflection : 0.100 (in)
6. Sugg. Max. Load : 5.200 (lbs)
7. All Drawing Dimensions are in Inches [mm]

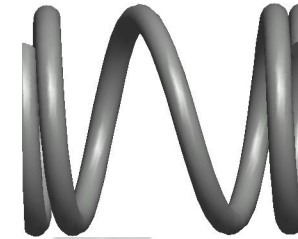

Ø 0.035
[0,89]
WIRE DIA

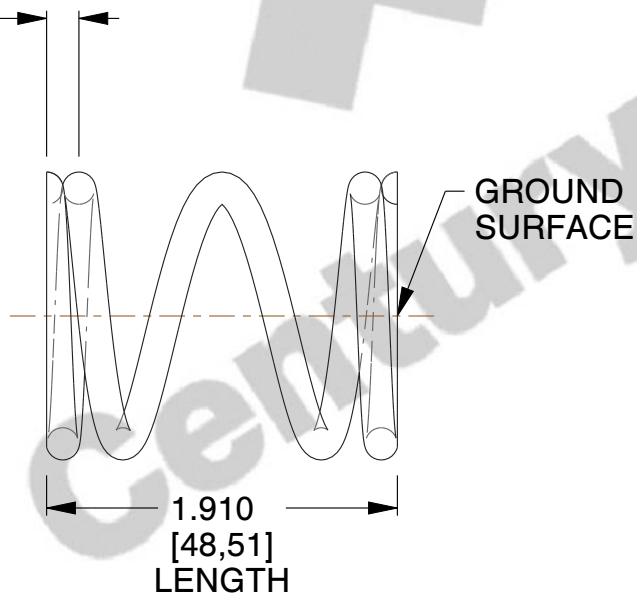

Ø 0.312
[7,92]
O.D

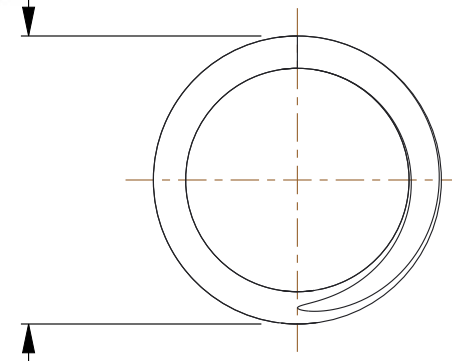

COMPONENT		SPRINGS	
Z-78 COMPRESSION SPRINGS		UNIT	
		INCH [mm]	
		SHEET	1 of 1